

Packing Equipment HR 16 (Code No. 18-1442-01)

The Packing Equipment HR 16 is intended for the efficient packing of GE Healthcare High Resolution (HR) columns, with diameter of 16 mm.

Dimensions

Length 375 mm
Internal diameter 16 mm

Unpacking

The Packing Equipment HR 16 contains:

- 1 Chromatographic tube HR 16/30
- 1 Connector 16/16 with O-rings
- 1 Inner end piece with O-ring
- 1 Outer end piece
- 1 Protective jacket HR 16/30 with O-rings
- 1 Preflanged tubing 40 cm
- 1 Wrench

Description

The Packing Equipment HR 16 is designed for efficient slurry packing of HR 16 columns. The Connector 16/16 connects your HR 16 column to the packing reservoir, the chromatographic tube HR 16/30.

The preflanged tubing is connected to the inner end piece. The chromatographic tube seals against the inner end piece, and the protective jacket is held in position by the Connector 16/16 and the outer end piece.

The materials of the packing consist of fluoroplastics, fluororubber, and glass.

Chemical and physical stability

The packing equipment resists aqueous solutions and nearly all organic solutions commonly used in chromatography, with the following exceptions: hydrocarbons, chlorinated hydrocarbons, and aromatic solvents.

The packing equipment stands pressures up to 3 MPa (30 bar, 430 psi).

Disassembling and reassembling

The figure indications below refer to the exploded diagram.

Disassembling

1. Unscrew the connector (4).
2. Pull off the protective jacket (2).
3. Unscrew the outer end piece (1).
4. Take out the inner end piece (3). If the inner end piece is difficult to remove, you can pry up the edge carefully with a spatula (see Fig. 1).

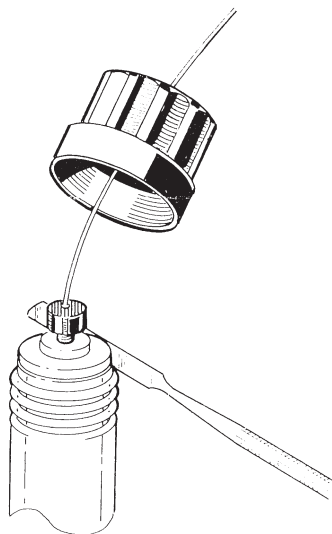

Fig. 1

Reassembling

1. Make certain that all parts are clean.
2. Screw the connector (4) onto the chromatographic tube (5).
3. Push the protective jacket (2) into the connector.
4. Wet the O-ring on the inner end piece (3) with ethanol.
5. Insert the inner end piece (3) with preflanged tubing.
6. Screw on the outer end piece (1).



Packing an HR 16 column

1. Assemble your column.
2. Connect the packing reservoir (chromatographic tube (5)) and protective jacket (2) to your column via the connector (4).
3. Pour the gel suspension into the column.
4. Fill the complete system with water or buffer.
5. Wet the O-ring on the inner end piece (3) with ethanol.
6. Insert the inner end piece (3) carefully into the tube without trapping air bubbles.
7. Connect the inlet tubing to the valve (pump).

Your column is now ready to pack.

Cleaning

Suitable cleaning agents are soapy water or laboratory detergents. The disassembled packing equipment may be autoclaved for 10 minutes at 120°C, excluding the protective jacket.

Spare parts

Part No.	Designation	Code No.	No. per pack
5	Chromatographic tube HR 16/30	19-7436-01	1
2	Protective jacket HR 16/30	18-3611-01	1
	Preflanged tubing 40 cm (i.d. 0.5 mm o.d. 1.8 mm)	18-0421-01	1
7	O-ring 27.1×1.6 mm	19-7595-01	5
6	O-ring 11.3×2.4 mm	19-7584-01	5
8	O-ring 17.86×2.62 mm	18-1426-01	5
3	Inner end piece	19-7846-01	1
1	Outer end piece	19-5167-01	1
4	Connector 16/16	18-1479-01	1

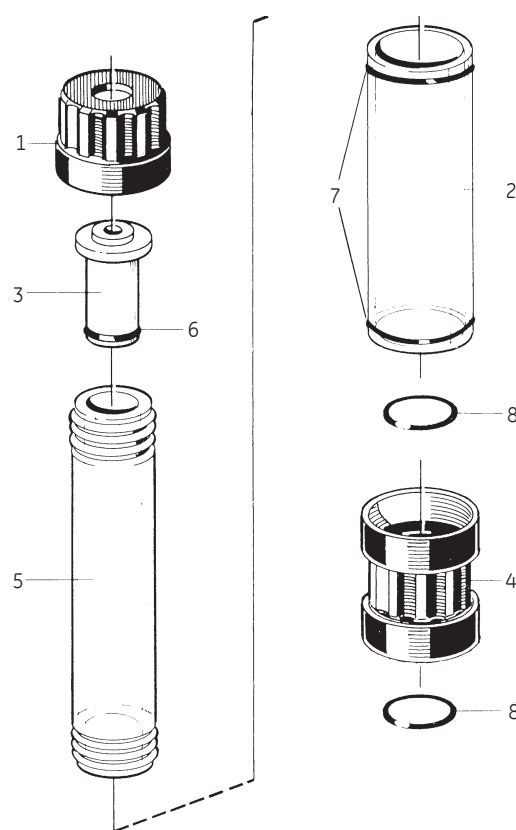

For contact information for your local office, please visit, www.gelifesciences.com/contact
www.gelifesciences.com

GE Healthcare Bio-Sciences AB
 Björkgatan 30
 751 84 Uppsala
 Sweden

GE, imagination at work, and GE monogram are trademarks of General Electric Company
 © 2007 General Electric Company – All rights reserved.

All goods and services are sold subject to the terms and conditions of sale of the company within GE Healthcare which supplies them. A copy of these terms and conditions is available on request. Contact your local GE Healthcare representative for the most current information

GE Healthcare Limited, Amersham Place, Little Chalfont, Buckinghamshire, HP7 9NA, UK

GE Healthcare Bio-Sciences Corp., 800 Centennial Avenue, P.O. Box 1327, Piscataway, NJ 08855-1327, USA

GE Healthcare Europe GmbH, Munzinger Strasse 5, D-79111 Freiburg, Germany

GE Healthcare Bio-Sciences KK, Sanken Bldg., 3-25-1, Hyakunincho, Shinjuku-ku, Tokyo, 169-0073 Japan



imagination at work